

# Shark®

## Rocket™

OWNER'S GUIDE

HV300UKS



Thank you for purchasing the Shark® Rocket™ Vacuum Cleaner.

This Owner's Guide is designed to help you get a complete understanding of your new vacuum cleaner. Please read it carefully and keep for future reference.

THANK YOU!

RECORD THIS INFORMATION:

Model Number: \_\_\_\_\_

Date of Purchase (Keep receipt):  
\_\_\_\_\_

TECHNICAL SPECIFICATIONS:



Voltage: 220-240V~, 50Hz  
Watts: 550W  
Power Nozzle: 80W

RECOMMENDED FILTER CLEANING SCHEDULE:

See the MAINTENANCE section for filter cleaning instructions

Filter Kit (Foam & Felt):    **XFFV300**    Once a month

This appliance complies with the European directives for electromagnetic compatibility (EMC) 2014/30/EU and its revisions, as well as Low Voltage Directive (LVD) 2014/35/EU and its revisions.

This marking indicates that this product should not be disposed with other household wastes throughout the EU. To prevent possible harm to the environment or human health from uncontrolled waste disposal, recycle it responsibly to promote the sustainable reuse of material sources. To return your used device, please use the return and collection systems or contact the retailer where this product was purchased. They can take this product for environmental safe recycling.



## IMPORTANT SAFEGUARDS

When using an electrical appliance, basic safety precautions should always be observed, including the following:

### **WARNING**

This appliance is not intended for use by persons with reduced physical, sensory or mental capabilities, or lack of experience and knowledge, unless they have been given supervision or instruction concerning use of the appliance by a person responsible for their safety.

Children shall not use or play with this appliance. Close supervision is necessary to keep appliance out of reach of children during use.

#### **TO REDUCE THE RISK OF FIRE, ELECTRIC SHOCK OR INJURY:**

- 1** DO NOT use outdoors or on wet surfaces.
- 2** Unplug from electrical outlet when not in use and before servicing.
- 3** DO NOT use with damaged cord or plug.
- 4** DO NOT USE if the appliance is not working, has been dropped, dropped into water, damaged or left outdoors.
- 5** NO SERVICEABLE PARTS. Incorrect re-assembly or repair can cause a risk of electrical shock or injury to persons when the appliance is used. Contact Customer Service.
- 6** DO NOT pull or carry vacuum cleaner by the cord or use the cord as a handle.
- 7** DO NOT unplug by pulling on cord; to unplug, grasp the plug, not the cord.
- 8** DO NOT handle plug or vacuum cleaner with wet hands.
- 9** DO NOT run the vacuum cleaner over the power cord, close a door on the cord or pull cord around sharp corners.
- 10** The use of an extension cord is not recommended.
- 11** DO NOT leave vacuum cleaner when plugged in.
- 12** Keep cord away from heated surfaces.
- 13** Turn off all controls before plugging or unplugging the vacuum cleaner.
- 14** Always turn off the vacuum cleaner before connecting or disconnecting Power nozzle.



**CAUTION:** Power nozzle contains electrical connections and the Power nozzle is not a serviceable part.

- 15** Store your vacuum cleaner with the power cord secured around the two cord holders - as shown in the storage instructions.

#### **GENERAL USE**

- 16** Use only as described in this manual.
- 17** DO NOT put any objects into openings. DO NOT use with any opening blocked; keep free of dust, lint, hair, and anything that may reduce air flow.

- 18** Keep your work area well lit.
- 19** Keep the vacuum cleaner moving over the carpet surface at all times to avoid damaging the carpet fibres.
- 20** DO NOT place vacuum cleaner on unstable surfaces such as chairs or tables.
- 21** DO NOT use without dust cup and/or filters in place.

#### **WAND ATTACHMENTS**

- 22** DO NOT use if air flow is restricted; if the air paths, the wand, or the accessories become blocked, turn the vacuum cleaner off. Remove all obstructions before you turn on the unit again.
- 23** Keep the end of the wand and accessory openings away from face and body.
- 24** Keep cleaning tools and wand suction openings away from hair, face, fingers, uncovered feet, or loose clothing.
- 25** Only use manufacturer's recommended attachments.

#### **DUST CUP/FILTERS/ACCESSORIES**

Before turning on the vacuum:

- 26** Make sure that all filters are thoroughly dry after routine cleaning.
- 27** Make sure that dust cup and all filters are in place after routine maintenance.
- 28** Make sure accessories are free of blockages.
- 29** Use only manufacturer's recommended accessories and replacement parts.

#### **GENERAL CLEANING**

- 30** DO NOT pick up large-sized objects.
- 31** DO NOT pick up hard or sharp objects such as glass, nails, screws or coins that could damage the vacuum cleaner.
- 32** DO NOT pick up smoking or burning objects such as hot coals, cigarette butts, or matches.
- 33** DO NOT pick up flammable or combustible materials such as lighter fluid, petrol, or kerosene or use vacuum in areas where they may be present.
- 34** DO NOT pick up toxic solutions such as chlorine bleach, ammonia, or drain cleaner.
- 35** DO NOT use in an enclosed space where vapours are present from paint, paint thinner, moth-proofing substances, flammable dust or other explosive or toxic materials.
- 36** DO NOT vacuum up any liquids.
- 37** DO NOT immerse vacuum cleaner in water or other liquids.
- 38** DO NOT use outdoors or on wet surfaces; use only on dry surfaces.
- 39** Use extra care when cleaning on stairs.

## SAVE THESE INSTRUCTIONS

## ASSEMBLY

- 1 Insert the tube into the floor nozzle connector.
- 2 Insert the handheld portion into the top of the tube.

## FLOOR CLEANING

**This vacuum has a 2-speed POWER slider switch, optimised for bare floor, delicate area rug and carpet cleaning.**

- 3 Plug the unit into an outlet. Slide the POWER switch to the first position to clean bare floor surfaces and delicate area rugs. The brush roll will spin slowly to help with debris pick-up.
- 4 Slide the POWER switch to the second position to clean carpets. The brush roll will spin faster to help pick up debris below the surface.

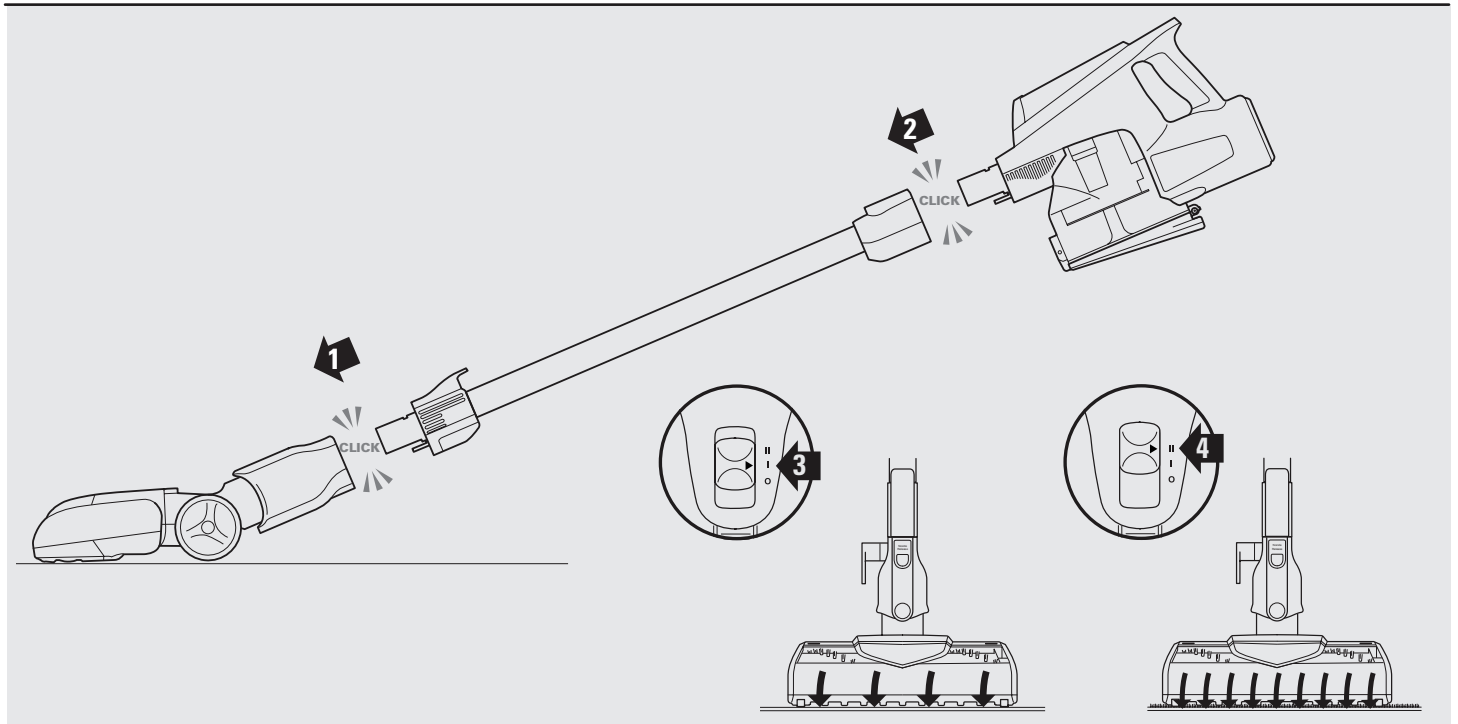

## ABOVE FLOOR CLEANING

**This vacuum has the reach to clean up above floors or in tight spaces by using the tube. It also has the convenience of a handheld vacuum when using it without the tube.**

- 1 Press the nozzle release button on the floor nozzle and pull to disconnect it from the end of the tube. Attach desired cleaning accessory.
- 2 Press the nozzle release button on the top of the tube and pull to disconnect it from the handheld portion. Attach desired cleaning accessory.

**NOTE:** Select cleaning accessories are included with this model.

*For a list of what is included with this model, refer to inside flap of box.*

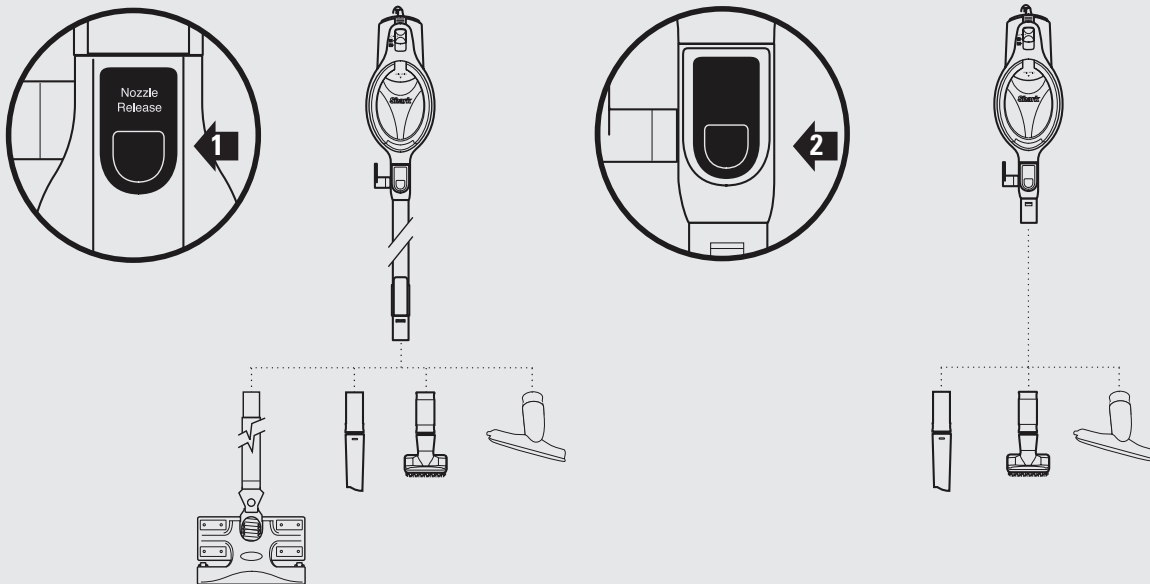

## STORAGE

**There are two recommended ways to store this vacuum.**

**OPTION 1:** Press the nozzle release button on the top of the tube and pull to separate it from the handheld portion of the vacuum. There is a hook on the bottom of the handheld portion. Hook it onto the hanger that is on the bottom portion of the tube. Wrap the cord around the two cord hooks. The unit is now ready to be stored.

**OPTION 2:** Use the wall mount that was included in the vacuum box. Using a Phillips head screwdriver, find a spot on the wall on which you would like to store this vacuum. Place each screw through the two holes in the wall mount and screw them into the wall. There is a hook on the bottom of the handheld portion. Hook it onto the hanger that is on the wall mount.

If you have plasterboard walls, use the plastic anchors provided before screwing wall mount in place.

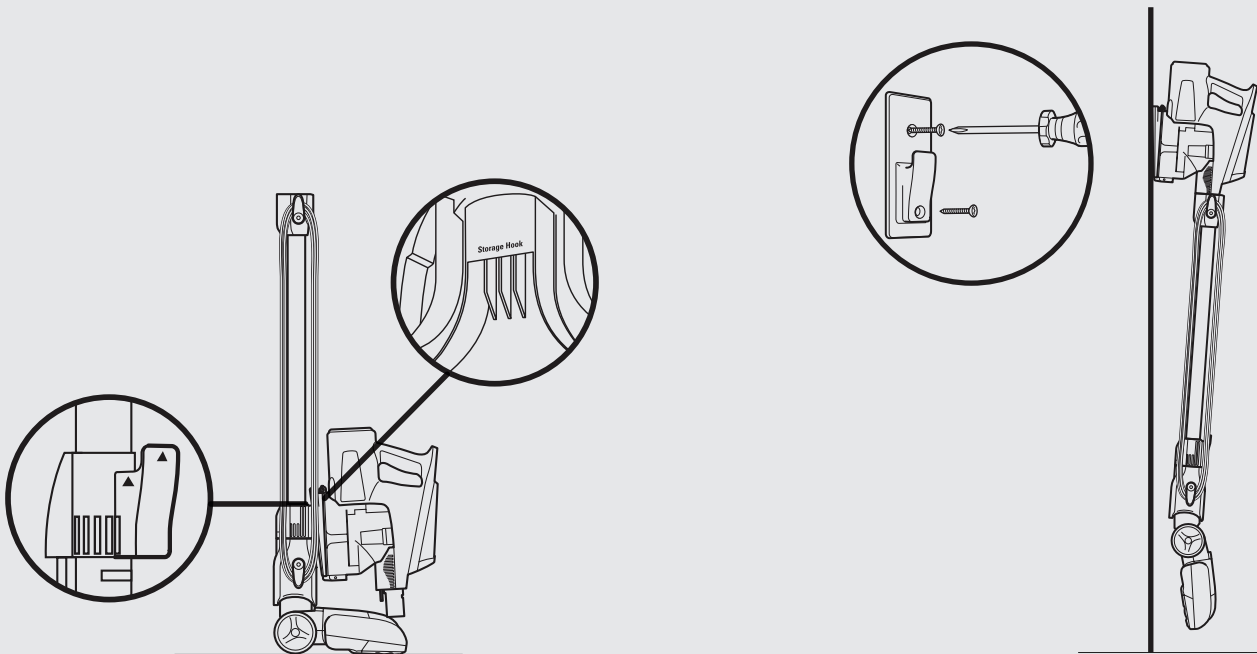

ACCESSORIES

NOTE: Select cleaning accessories are included.

For a list of what is included with this model, refer to inside flap of box.

14 CM CREVICE TOOL

For hard to reach places.

226FFJV300

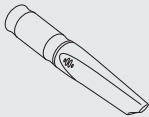

DUSTING BRUSH

Cleans hard surfaces and upholstery.

229FFJV300



PET HAIR TOOL

Removes pet hair and dust from curtains or delicate fabrics and upholstery.

231FFJV300

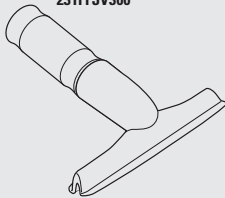

DUST-AWAY™ HARD FLOOR TOOL - SEE PAGE 8

Vacuums and dusts bare floors using washable pads.

XDAV300

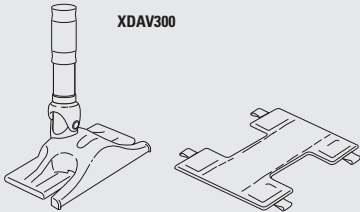

## DUST-AWAY™ HARD FLOOR ATTACHMENT & CLEANING PADS INSTRUCTIONS

### MICROFIBRE PAD

- 1 Slip two of the tabs between the suction nozzle and the duster base and attach them to the front fasteners on the base. Then pull the other two tabs tightly around to the back fasteners on the base. For best results, ensure that the pad is flat against the bottom surface and secured tightly.
- 2 Use the Dust-Away™ to clean dry bare floor surfaces. Do not use to clean damp floors or wet/sticky messes. Only use pads provided by Shark®, which are designed to work with the Dust-Away™ attachment.
- 3 Wash the pads separately with warm water either in the washing machine or by hand using liquid detergent.  
Do not use bleach or fabric softeners as they may damage or leave a coating that will reduce the cleaning performance of the pads.  
Tumble dry low or line dry to extend the life of the microfibre fabric.  
For best floor cleaning results, we recommend replacing your microfibre pads every 3-4 months following normal use.

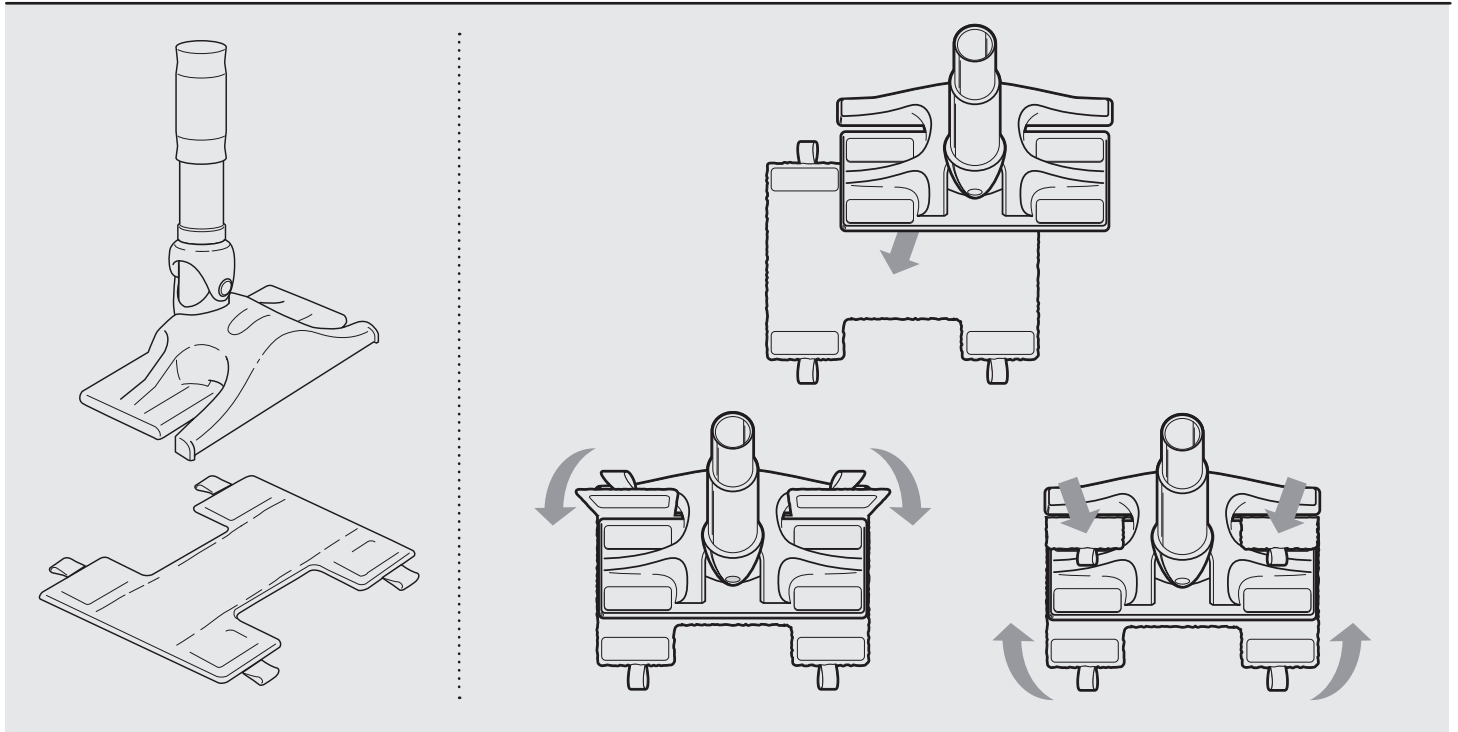



## MAINTENANCE

### EMPTY THE DUST CUP

- 1 Detach the handheld portion from the rest of the vacuum by pressing the coloured button on the top of the tube to pull it away from the handheld portion.
- 2 Holding the dust cup over a refuse bag or bin, press the release button on the front of the dust cup. The bottom lid will open, allowing the debris to fall out.
- 3 Clean the dust screen inside the dust cup as required.

### CLEAN THE FILTERS

See cleaning schedule on page 2

- 4 Access the filters by lifting the latch on the top of the handheld portion of the vacuum. Remove and rinse the foam and felt filters every month. Let air dry completely before replacing. Hand wash only. Tap loose dirt off filters between washes as needed. Insert the felt filter first and then place the foam filter on top of it.

### CHECK FOR BLOCKAGES

#### REMOVE AND INSPECT:

##### HANDHELD AND TUBE

- 5 Remove the tube from the handheld portion and check all dust cup intake openings. Remove the floor nozzle from the tube and check the tube for blockages.

##### BOTTOM OF FLOOR NOZZLE

- 6 Use a coin to unlock the three locks on the bottom of the floor nozzle. A portion of the base is removable to allow for better access to the brush roll and exposure to the airway. Shine a torch from the bottom to check for possible blockage in the airway.
- 7 Remove any string, carpet fibres or hair that may be wrapped around the brush roll. There is a groove on the brush bar that allows a pair of scissors to cut across it to loosen up the debris.

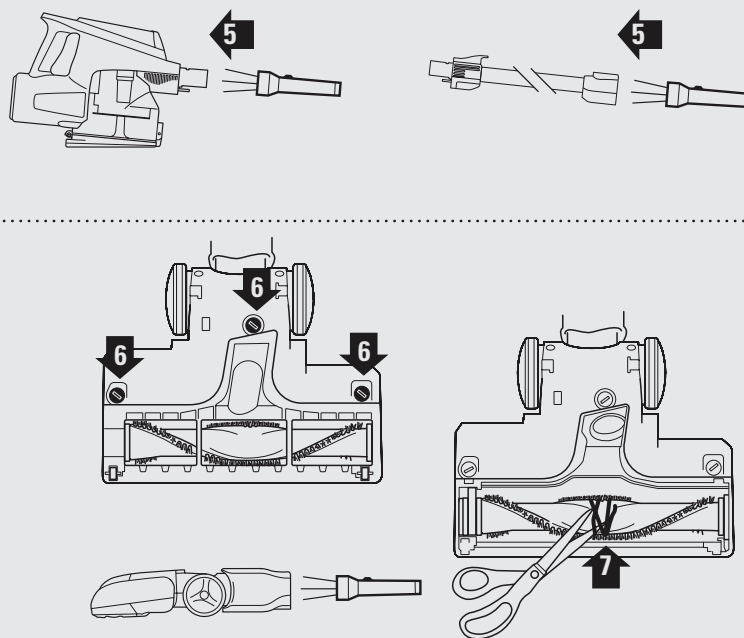
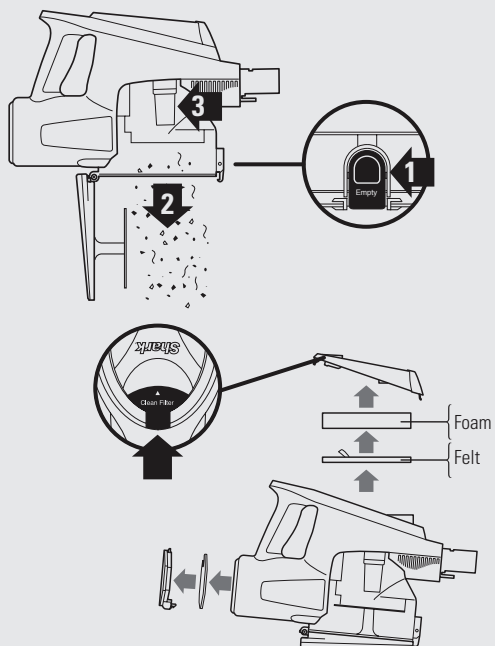

## TROUBLE- SHOOTING GUIDE

### **Vacuum is not picking up dirt. No suction or light suction.**

- Check filters to see if they need cleaning. Follow instructions for rinsing and drying the filters before re-inserting back into the vacuum.
- Dust cup may be full; empty dust cup.
- Check tube, tube connections, nozzles and accessories for blockages; clear blockages if required.

### **Vacuum lifts area rugs**

- Suction is powerful. Take care when vacuuming area rugs or rugs with delicately sewn edges.
- Turn off the unit to disengage the brush roll and restart with the POWER button.

### **Brush roll does not spin**

- Immediately turn off and unplug vacuum, disconnect the nozzle and remove blockage before reconnecting and turning vacuum back on.
- This vacuum is equipped with a thermal shut down safety feature in the event that your vacuum over heats. If your vacuum does shut down, slide the POWER switch to the “0” position and unplug the unit. After about 30 minutes, your vacuum should be ready to operate again. Plug in the power cord and turn the unit on to begin vacuuming again.

## WARRANTY TERMS AND CONDITIONS

The conditions below describe the prerequisites and scope of our warranty. They do not affect your statutory rights or the obligations of your retailer and your contract with them.

### Shark® Guarantees

A household appliance like a vacuum cleaner constitutes a sizeable investment. Your new machine needs to work properly for as long as possible. The guarantee it comes with is an important consideration - and reflects how much confidence the manufacturer has in its product and manufacturing quality.

Every Shark® machine comes with a free parts and labour guarantee. Our customer service helpline (**0800 862 0453**) is open from 9.00am to 6.00pm Monday - Friday. It's free to call, and you'll be put straight through to a Shark representative. You'll also find online support at **[www.sharkclean.eu/uk](http://www.sharkclean.eu/uk)**.

### How do I register my extended Shark® guarantee?

You can register your guarantee online within 28 days of purchase. To save time, you'll need the following information about your machine:

- Serial number (on the machine rating label)
- Date you purchased the machine (receipt or delivery note)
- To register online, please visit **[www.sharkclean.eu/uk/register-guarantee](http://www.sharkclean.eu/uk/register-guarantee)**

### IMPORTANT

- Both the 12 months and the extended 4 years guarantee will only cover your product from the date of purchase.
- Please keep your receipt at all times. Should you need to use your extended guarantee we will need your receipt to verify the information you have supplied to us is correct. The inability to produce a valid receipt may invalidate your guarantee.

### What are the benefits of registering my free Shark® guarantee?

When you register your guarantee we'll have your details to hand if we ever need to get in touch. You can also receive tips and advice on how to get the best out of your Shark® vacuum and hear the latest news about new Shark® technology and launches.

If you register your guarantee online, you'll get instant confirmation that we've received your details.

### How long are new Shark® machines guaranteed for?

Our confidence in our design and quality control means that your new Shark® vacuum cleaner is guaranteed for a total of three years. (12 months plus an extended warranty of 4 years).

### What is covered by the free Shark® guarantee?

Repair or replacement of your Shark® machine (at Shark®'s discretion), including all parts and labour. A Shark® guarantee is in addition to your legal rights as a consumer.

### What is not covered by the free Shark® guarantee?

- Blockages – For details of how to unblock your vacuum cleaner, please refer to the Operating Manual.
- Normal wear and tear such as brush bar, fuse, belt, batteries etc.
- Accidental damage, faults caused by negligent use or care, misuse, neglect, careless operation or handling of the vacuum cleaner which is not in accordance with the Shark® Operating Manual supplied with your machine.
- Use of the vacuum cleaner for anything other than normal domestic household purposes.
- Use of parts not assembled or installed in accordance with the operating instructions.
- Use of parts and accessories which are not Shark® Genuine Components.
- Faulty installation (except where installed by Shark®).
- Repairs or alterations carried out by parties other than Shark or its agents.

### What happens when my guarantee runs out?

Shark® does not design products to last for a limited time. We do appreciate that there may be a desire for our customers to want to repair their vacuum cleaners after the warranty has elapsed. In this case please contact our free phone customer service help line and ask about our out warranty program, on **0800 862 0453**.

### Where can I buy genuine Shark® spares and accessories?

Shark® spares and accessories are developed by the same engineers who developed your Shark® vacuum. You'll find a full range of Shark® spares and replacement parts for all Shark® machines at **[www.sharkclean.eu/uk/parts](http://www.sharkclean.eu/uk/parts)**. Accessories are at **[www.sharkclean.eu/uk/accessories](http://www.sharkclean.eu/uk/accessories)**.

Please remember that using non-Shark® spares invalidates your guarantee.

# ***Shark***®



Euro-Pro Europe Limited  
15 Mariner Court  
Calder Park  
Wakefield  
WF4 3FL

Freephone 0800 862 0453  
[www.sharkclean.eu](http://www.sharkclean.eu)

