

ISOMETRIC VIEW

TPS SHAFT AND ADAPTOR TO BE SPECIFIED BY CUSTOMER



COPYRIGHT (c) 2013
AT POWER LTD
UNIT 9, CHESTNUT DRIVE, WYMONDHAM,
NORFOLK, UK, NR18 9SB

UNLESS OTHERWISE STATED:
DIMENSIONS IN MILLIMETRES
TOLERANCES: LINEAR ± 0.1 ANGULAR ± 0.5°
SURFACE FINISH √ = √
DRAWING STANDARDS TO ATQS 6003
DATE FORMAT: DD/MM/YY

THIS DESIGN IS THE PROPERTY OF
ACTIVE TECHNOLOGIES LTD AND
MUST NOT BE REPRODUCED OR
COMMUNICATED WITHOUT
AUTHORITY

CAD PLOT
DO NOT
SCALE

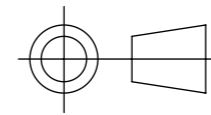

THIRD ANGLE PROJECTION

SCALE 1:1 WEIGHT 0.3 kg

DRAWN- M.DAVIS

DATE - 29/07/14

CHECKED - S.HOW

APPROVED - A.CLIFTON

MATERIAL

SEE COMPONENT PARTS

FINISH

SEE COMPONENT PARTS

DRAWING TITLE

ASSY - SINGLE BORE -
65MM

DRAWING NUMBER

102-120-00011