

BASIC INSTALLATION GUIDE

Please note: This is only a guide and we always recommend that you use professional installers for our products as incorrect installation or preparation of the subfloor would void warranty. Installation should be in accordance with Australian Standards – AS 1884 – 2012 Floor Coverings – Resilient Sheet and Tiles – Installation Practices.

PRIOR TO LAYING

* Prior to installation the flooring should be removed out of the boxes and stacked in piles not greater than 5 boxes high 24 hours before installation and acclimatized within a set temperature between 65°(18°C) and 85°F (28°C). (Do not attempt to install this flooring outside of the recommended temperature unless you are a skilled installer as correct measures need to be taken to prevent issues arising in the floor such as buckling.)

SUBFLOOR PREPARATION

* Engineered Click Lock Flooring can float over existing hard level surfaces such as timber, concrete, existing vinyl and even ceramic tiles. (It is important to note that all substrates need to be level before laying the Engineered Click Lock flooring otherwise you can encounter imperfections in the floor that maybe present during and after the installation.)

* Any uneven surfaces will need to be levelled with levelling compounds or other material suitable for the application, please talk to a professional for the best advice for your subfloor.

INSTALLATION TOOLS

- Stanley Knife
- Straight Edge
- Tape Measure
- Marking Pencil
- Hammer and tapping block
- Chalk Line
- Pull Bar (Optional but Advantageous)
- Table Saw, Jig Saw & Miter Saw (Optional)
- Safety Glasses
- Dust Mask
- Safety Gloves

STEP 1

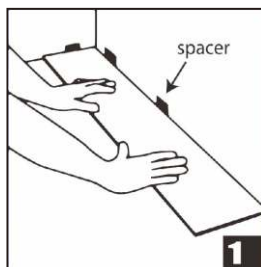

Start at a corner. Place first plank with tongue side facing wall. Use spacers to maintain an expansion space of 2-3 mm between wall and flooring.

STEP 2

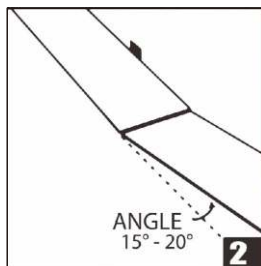

Insert 2nd plank's end tongue to 1st plank's end groove at an angle of 15° to 20°. The plank will click into place when lowered. Line up edges carefully. Planks should be flat to the floor.

STEP 3

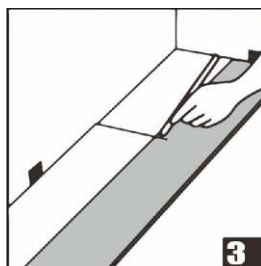

For the last plank of a row, flip a full plank to its under side and place beside the row. Measure and mark the required length. Use a ruler and utility knife to score the plank and snap off. Insert as previous diagram.

STEP 4

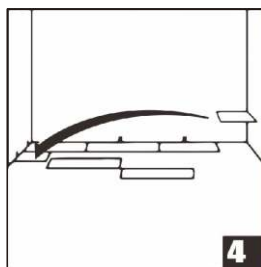

Begin next row with the last cut off piece from the previous row to stagger the pattern.

STEP 5

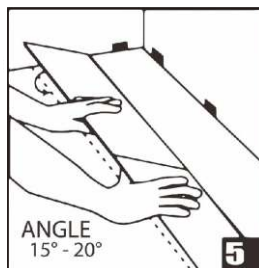

To start second row, assemble your entire row on the subfloor before attaching it to the first row.

To attach, tilt and push the side tongue into the side groove of the first row at an angle of 15° to 20°.

Lower and click into place lining the edges up carefully. Continue laying remaining planks in this manner.

STEP 6



To fit the final row, lay a plank upside down on the flooring as per diagram with the tongue side close to the wall.

Take another plank and place it right on top of the previous row and use it as a rule.

Don't forget to allow room for spacers. Cut the plank and attach into position.

STEP 7

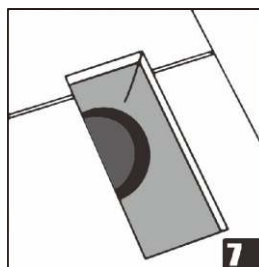

Heating vents require expansion room.

First, cut plank to the correct length.

Place the cut plank at its actual position and use a ruler to measure the areas to be cut out and mark them.

Cut out the marked points allowing the necessary expansion distance.

STEP 8



The gap between the bottom of a door and the vinyl flooring should be 1 cm height.

To trim door frames, turn a plank upside down.

Place it next to the door frame as per diagram.

Use a handsaw and cut away the necessary height so that the planks can slide easily underneath the frame.

AFTER INSTALLATION / FLOOR CARE & MAINTENANCE

- Sweep up all rubbish and debris that are on the floor using a soft bristle broom.
- Any spare material left over should be stored away for future replacement if required.
- Install trims or existing skirting to cover the expansion gaps and transition strips where required.
- When moving furniture back on the flooring make sure to properly protect the flooring.
- Use felt protectors on furniture legs.
- Avoid rubber and petroleum-based products such as tires, casters, floor mats or asphalt sealers as these may contain chemicals that can permanently stain flooring.
- Clean the floor with a non-abrasive cleaning solution or warm soapy water using a PH neutral detergent as strong cleaner can cause permanent damage to your flooring.
- Wipe up spills immediately with a damp cloth to prevent staining.
- Sweep and vacuum the floor regularly to keep your floors looking beautiful and new for longer.
- Avoid long periods of sun exposure to the flooring by closing blinds and drapes on peak sunlight hours. This can cause colour fading and buckling in your floor due to extreme surface temperatures.